

### Returning to Sorority Village after a home game

- ◆ 1st Priority—Police are moving traffic away from stadium and off campus
- ◆ Usually takes 2 hours

#### Options:

- ◆ ONLY right hand turns are allowed into the village
- ◆ Tell Uber, Lyft, & your friends bringing you back—these restrictions
- ◆ OR—Stay away from Sorority Village until the traffic clears

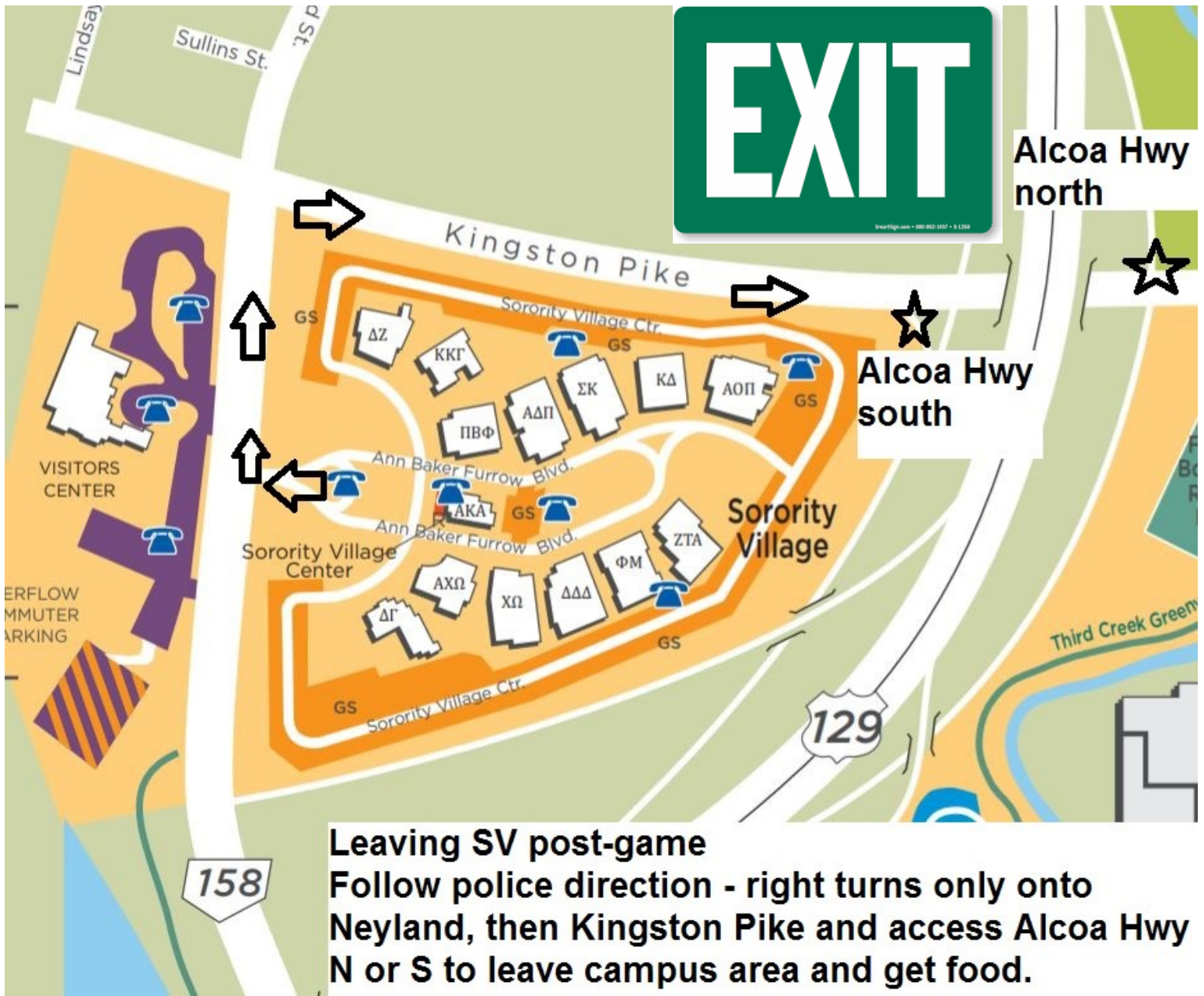

#### Leaving Sorority Village when police are present

- ◆ 1st Priority—Police are moving traffic away from stadium and off campus
- ◆ They might not let traffic exit for a while, it is up to their guidance on traffic volume

#### Reminders:

- ◆ ONLY right hand turns are allowed out of the village
- ◆ IF you order food for delivery—tell them there are NO LEFT TURNS into the village
- ◆ OR—Go grocery shopping prior and stay in Sorority Village until the traffic clears



## GETTING AROUND UT November 2021 Sorority Village Gameday Edition

EAST TENNESSEE CHILDREN'S HOSPITAL

### Support Children's Hospital by parking on game day.

Going to the game at Neyland Stadium this Saturday?

Parking is available at these Children's Hospital locations:

- 1- \$15 Employee parking garage at 22<sup>nd</sup> and White Ave.
- 2- \$20 for outdoor surface lot and White Ave. Easy access!
- 3- UT Federal Credit Union between 21<sup>st</sup> and 22<sup>nd</sup> Streets. \$30 Non-SEC \$40 SEC
- 4- \$25 Grand Warehouse

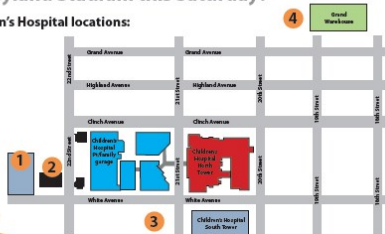

All funds raised will go towards programs and services at Children's Hospital and directly impact the patients we serve.

Follow the **BLUE ARROWS** for easy, no block parking.

Parking to benefit Children's Hospital



Thank you for your support, and **Go Vols!**

\*Prices may vary on certain weeks.



### Football Donor Shuttle- Ag campus to Neyland Stadium

- Shuttles for football donors begin 3 hours prior to game time from the Ag Campus on River Dr across from the CF parking area to Neyland Stadium.
- The return trips begin when the 3rd quarter ends
- The buses are lined up on Volunteer Blvd from Art & Architecture to McClung Tower.

*During Basketball season there shuttles also run from Ag campus to Thompson-Boling Arena 2 hours prior to tip-off.*

### Close Public Parking options

#### UT Campus (\$25 cash only)

- ♦ Visitor Center (no shuttle service) (180 spaces)

#### East TN Children's Hospital (\$15-40 cash only) (picture at top of page)

- ♦ Various lots north of Cumberland Ave

#### City of Knoxville (\$25 credit card only)

- ♦ Parking meters on White Ave north of Cumberland Ave and a few other side streets off White

#### University Commons (\$40 cash only)

### Safety

**PLEASE DO NOT** walk to Neyland Stadium all the way on Neyland Dr

Use Cumberland Ave—continuous sidewalks and great lighting the entire walk

Never walk alone—at least pairs if not groups

## BAG POLICY

### APPROVED BAGS

