

Returning to Sorority Village after a home game

- ◆ 1st Priority—Police are moving traffic away from stadium and off campus
- ◆ Usually takes 2 hours

Options:

- ◆ ONLY right hand turns are allowed into the village
- ◆ Tell Uber, Lyft, & your friends bringing you back—these restrictions
- ◆ OR—Stay away from Sorority Village until the traffic clears

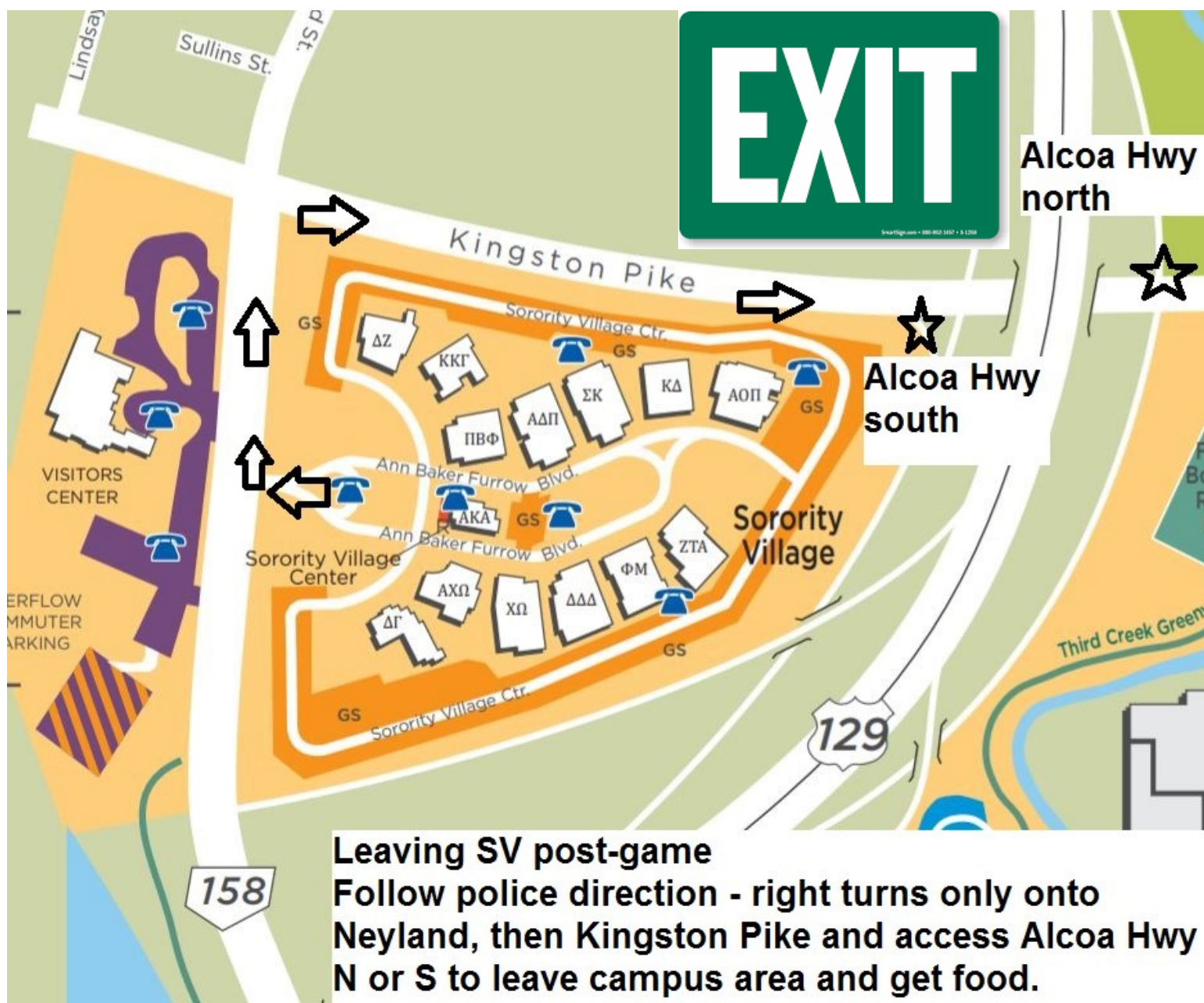

Leaving Sorority Village when police are present

- ◆ 1st Priority—Police are moving traffic away from stadium and off campus
- ◆ They might not let traffic exit for a while, it is up to their guidance on traffic volume

Reminders:

- ◆ ONLY right hand turns are allowed out of the village
- ◆ IF you order food for delivery—tell them there are NO LEFT TURNS into the village
- ◆ OR—Go grocery shopping prior and stay in Sorority Village until the traffic clears

EAST TENNESSEE CHILDREN'S HOSPITAL

Support children's Hospital by parking on game day.

Going to the game at Neyland Stadium this Saturday?

Parking is available at these Children's Hospital locations:

- 1- \$15 Employee parking garage at 22nd and White Ave.
- 2- \$20 Outdoor parking at 22nd and White Ave. Easy access!
- 3- \$30 non SEC games and \$40 SEC games Outdoor parking at 20th and White Ave.
- 4- \$25 Parking is also available off Grand Avenue near 18th Street. Easy access to I-40 after the game.

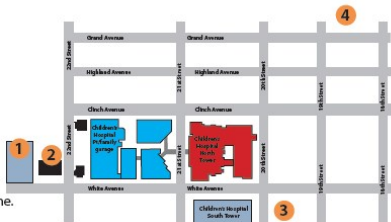

All proceeds benefit East Tennessee Children's Hospital.

Follow the BLUE ARROWS for easy, no block parking.

Parking to benefit Children's Hospital



Thank you for your support, and Go Vols!

*Prices may vary on certain weeks.



Close Public Parking options

UT Campus (\$25 cash only)

- ◆ Visitor Center (no shuttle service) (180 spaces)
- ◆ Old Sports Bubble (Andy Holt Ave) (100 spaces)
- ◆ S12 - Lake Ave (near Kappa Sigma) (40 spaces)

East TN Children's Hospital (\$15-40 cash only) (picture at top of page)

- ◆ Various lots north of Cumberland Ave

City of Knoxville (\$25 credit card only)

- ◆ Parking meters on White Ave north of Cumberland Ave and a few other side streets off White



Football Shuttle-Ag campus to Neyland Stadium

- Shuttles for football donors begin 3 hours prior to game time from the Ag Campus by Pendergrass Library to Neyland Stadium.
- The return trips begin when the 3rd quarter ends
- The buses are lined up on Volunteer Blvd from Art & Architecture to McClung Tower.

During Basketball season there shuttles also run from Ag campus to Thompson-Boling Arena.

Safety

PLEASE DO NOT walk to Neyland Stadium all the way on Neyland Dr

Use Cumberland Ave— continuous sidewalks and great lighting the entire walk

Never walk alone—at least pairs if not groups

BAG POLICY

APPROVED BAGS



CLEAR BAG
 NO LARGER THAN
 12" x 6" x 12"



CLEAR PLASTIC STORAGE BAG
 ONE GALLON RESEALABLE



SMALL CLUTCH PURSE
 NO LARGER THAN
 4.5" x 6.5"



SEAT CUSHION
 NO ARMS OR POCKETS